

PURPOSE:	DIVISION	AREA NAME:	MOUNT BARKER	APPROVED:	
MAP REF:	66277/M	COUNCIL:	MOUNT BARKER DISTRICT COUNCIL	DEPOSITED/FILED:	
LAST PLAN:		DEVELOPMENT NO:	580/D032/18/004		SHEET 1 OF 1
					115489_text_01_v01

AGENT DETAILS:	BLEEZE NEALE & ASSOCIATES PTY LTD 27, 19TH ST GAWLER SOUTH SA 5118 PH: 75067966 FAX:	SURVEYORS CERTIFICATION:
AGENT CODE:	BLNE	
REFERENCE:	G1414-STG3	

SUBJECT TITLE DETAILS:

PREFIX	VOLUME	FOLIO	OTHER	PARCEL	NUMBER	PLAN	NUMBER HUNDRED / IA / DIVISION	TOWN	REFERENCE NUMBER
PT CT	6270	557		ALLOTMENT(S) COMPRISING PIECES	(962*.2022*)	D	? MACCLESFIELD		

OTHER TITLES AFFECTED:

EASEMENT DETAILS:

STATUS	LAND BURDENED	FORM	CATEGORY	IDENTIFIER	PURPOSE	IN FAVOUR OF	CREATION
NEW	305	SERVICE	EASEMENT(S)	K(T/F)	FOR ELECTRICITY SUPPLY PURPOSES	DISTRIBUTION LESSOR CORPORATION (SUBJECT TO LEASE 8890000)	223LG RPA

ANNOTATIONS:

PIECES SCHEDULE

ONE ALLOTMENT COMPRISES	TOTAL AREA
3001* 970*	18.53ha

*Asterisk denotes PIECE identifier only

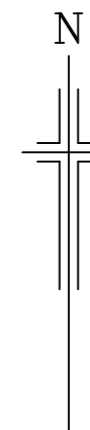
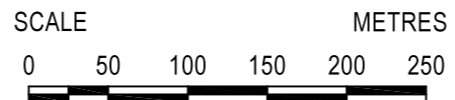

BEARING DATUM:	
DERIVATION:	
DRAWING SCALE FACTOR:	1
ORIGIN POINT:	
TOTAL AREA:	20.1ha

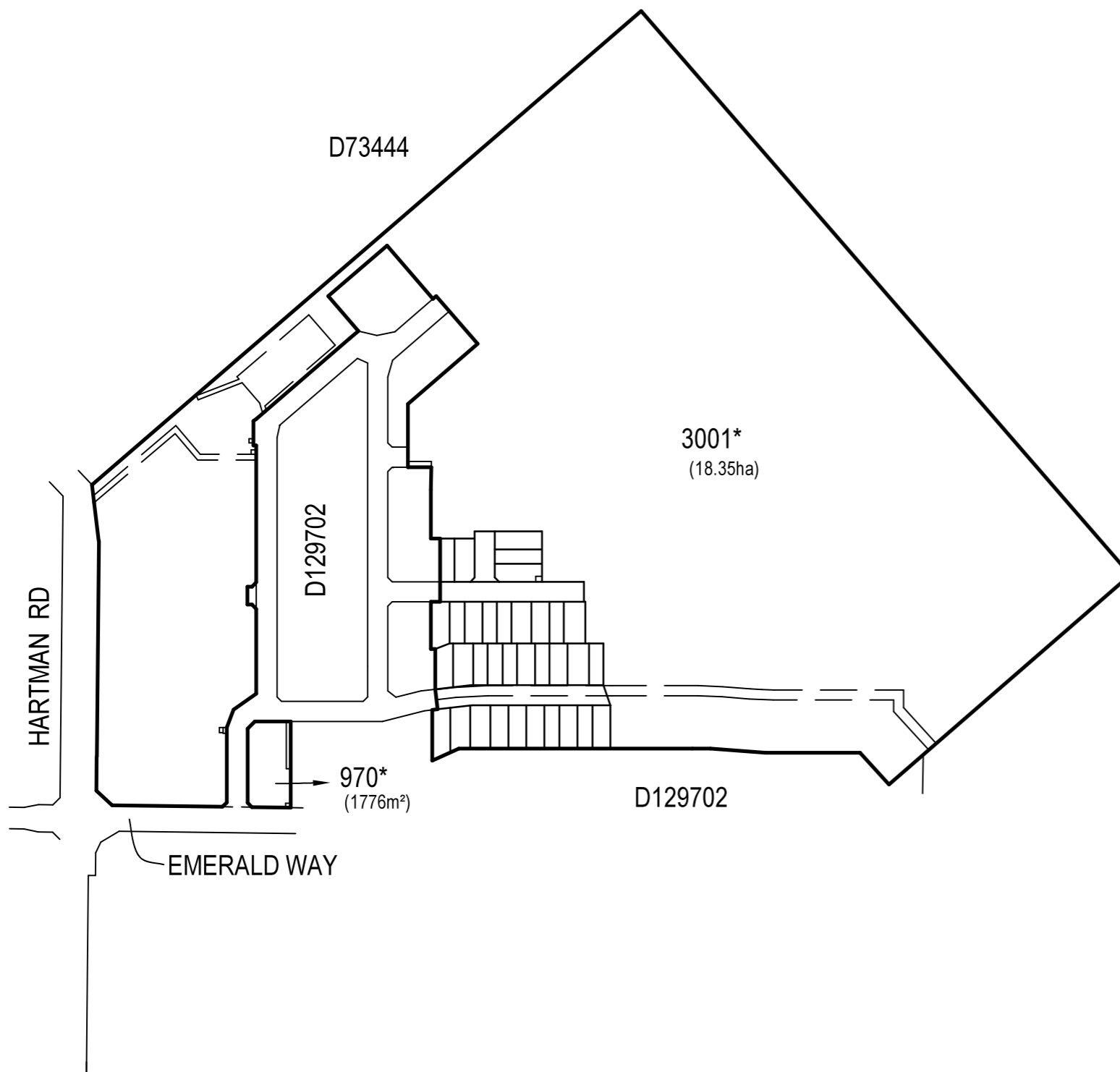

BLEEZE NEALE & ASSOC. PTY. LTD.
 SURVEYING CONSULTANTS ACN 008 174 070
 27 19TH STREET, GAWLER SOUTH, SA, 5118
 10/230 MAIN SOUTH ROAD, MORPHETT VALE, SA, 5132
 Tel (08) 7506 7966 Email: admin@bleezenealesurveyors.com

Date	DR	SVY
REF G1414 ST3		

ENLARGEMENT Z3

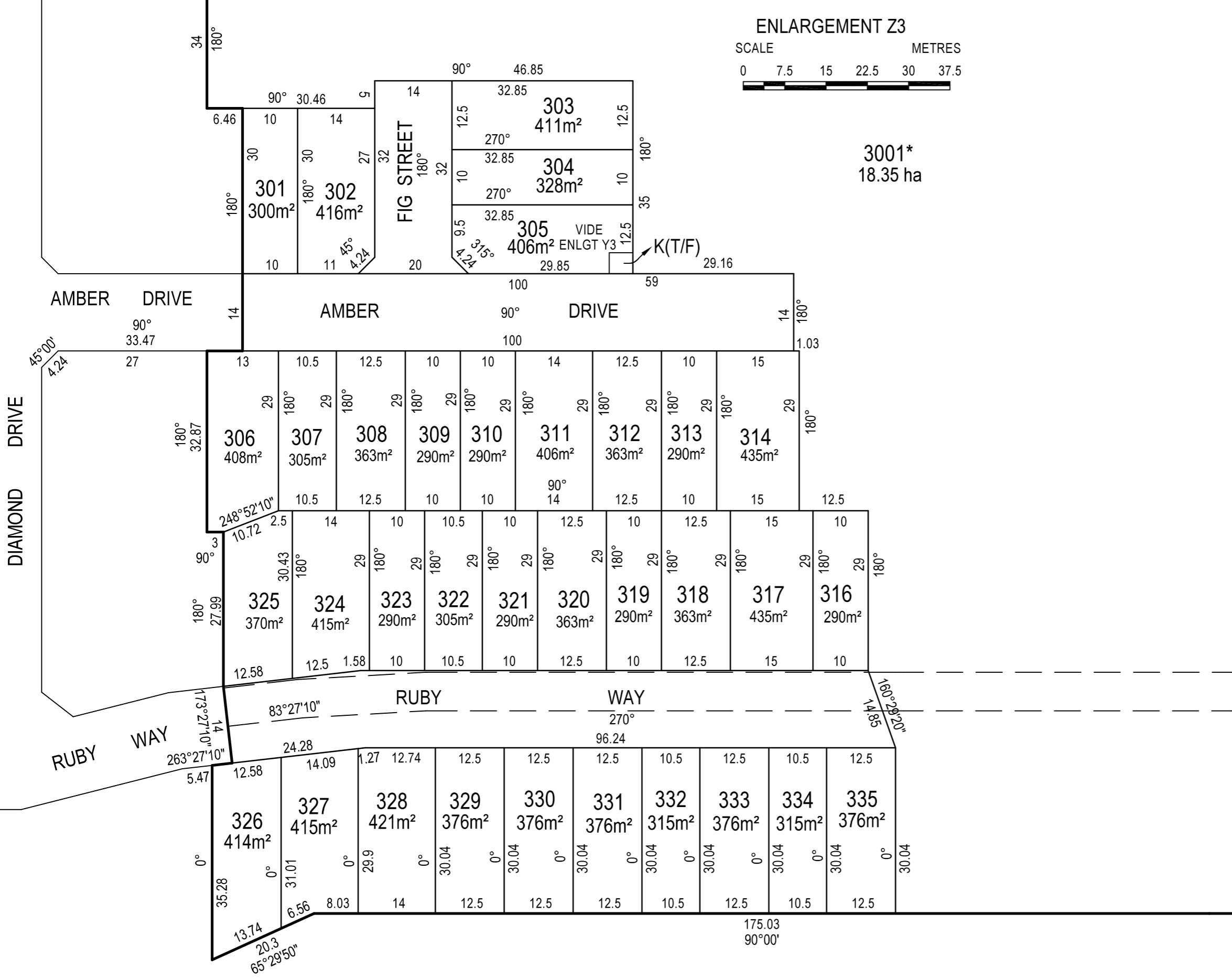
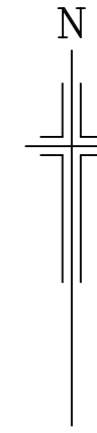
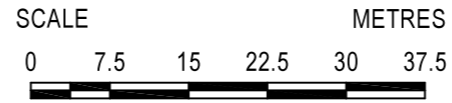

3001*
18.35 ha

ENLARGEMENT Y3
NOT TO SCALE

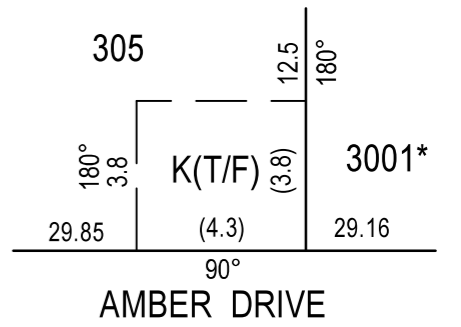

BLEEZE NEALE & ASSOC. PTY. LTD.
 SURVEYING CONSULTANTS ACN 008 174 070
 27 19TH STREET, GAWLER SOUTH, SA, 5118
 10/230 MAIN SOUTH ROAD, MORPHETT VALE, SA, 5132
 Tel (08) 7506 7966 Email: admin@bleezenealesurveyors.com

Date DR SVY

REF G1414 ST3